

## SWITCH CONTINUITY CHART

Two Speed Motor  
(With Non-Concealed Wipers)

Off	Low	High
B to B/U. B to P1. A to P2. H-open	B to B/U. B to P1. B to A. P-2 open H-open	B to B/U. B to P1. B to H. P2-open A-open

## SWITCH CONTINUITY CHART

Two Speed Motor  
(With Concealed Wipers)

Off	Low	High
B to P. A to Ground F2-Open H-Open	B to A. F2 to Ground P-Open H-Open	B to H. F2 to Ground P-Open A-Open

## MOTOR REPAIR TWO SPEED (Fig. 7)

If the motor is found to be defective after tests, disassemble the motor as follows:

**Disassembly**

- (1) Remove wiper motor.
- (2) Mount motor assembly in a vise.
- (3) Remove motor housing through bolts.

- (4) Remove motor housing and armature assembly.
- (5) Remove flat washers and spring washer.

**Repair**

- (1) Inspect motor housing for following items:
  - (a) Foreign material,
  - (b) magnets, retaining clips or bearing retainers are loose or broken,
  - (c) plastic thrust bearing missing or damaged. Thrust bearing can be seen by looking through center of bearing in bottom of motor housing.
 If any of these conditions exist replace housing.
- (2) Test Armature as follows:

**Testing Armature for Short Circuit**

Place armature in growler and hold a thin steel blade parallel to the core and just above it, while slowly rotating armature in growler. A shorted armature will cause blade to vibrate and be attracted to the core. Replace armature if shorted.

**Testing Armature for Ground**

Contact armature shaft and each of the commutator riser bars with a pair of test lamp probes. If lamp lights, it indicates a grounded armature. Replace grounded armature.

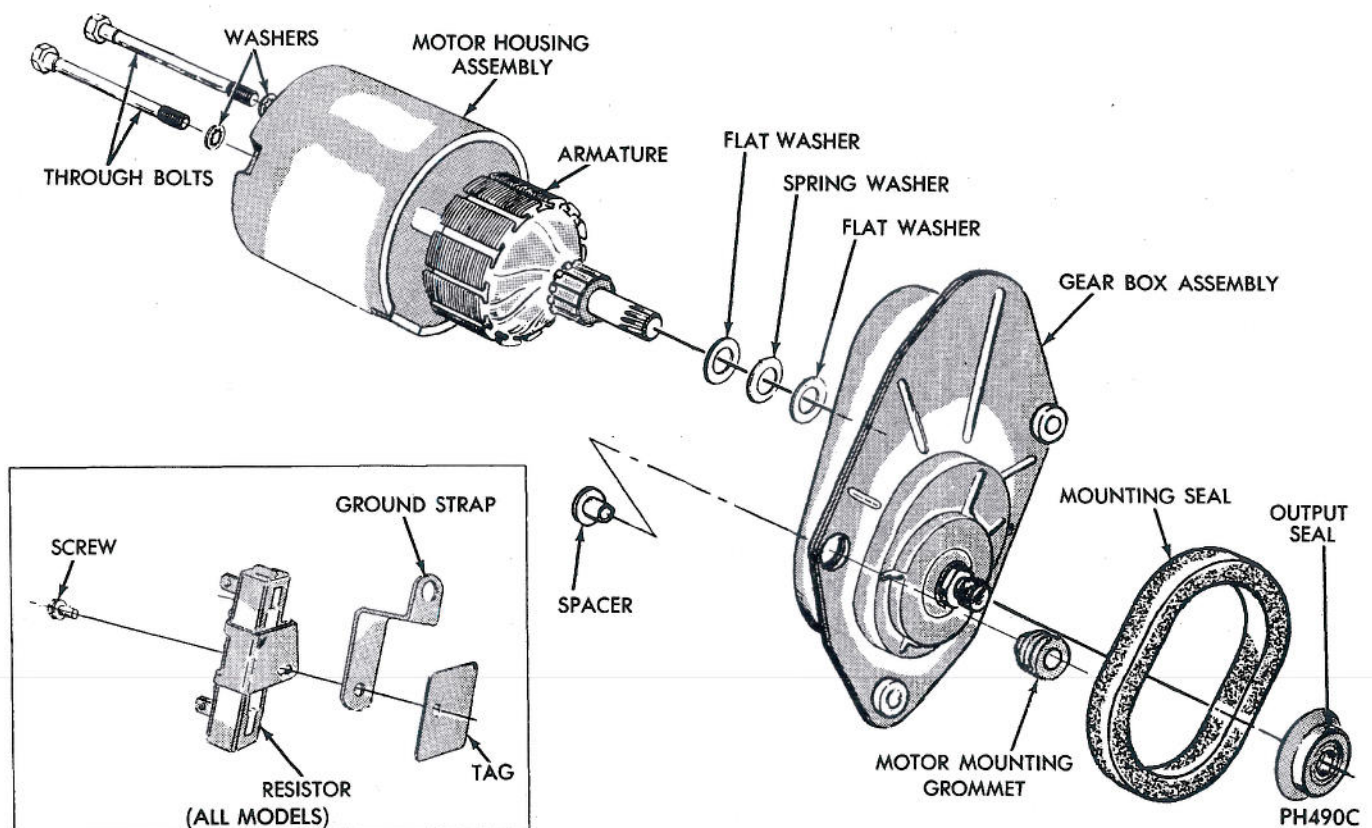

Fig. 7—Two Speed Wiper Motor (Exploded View)