

9104 500

## PARKING BRAKE CONTROLS - H,N,F,G

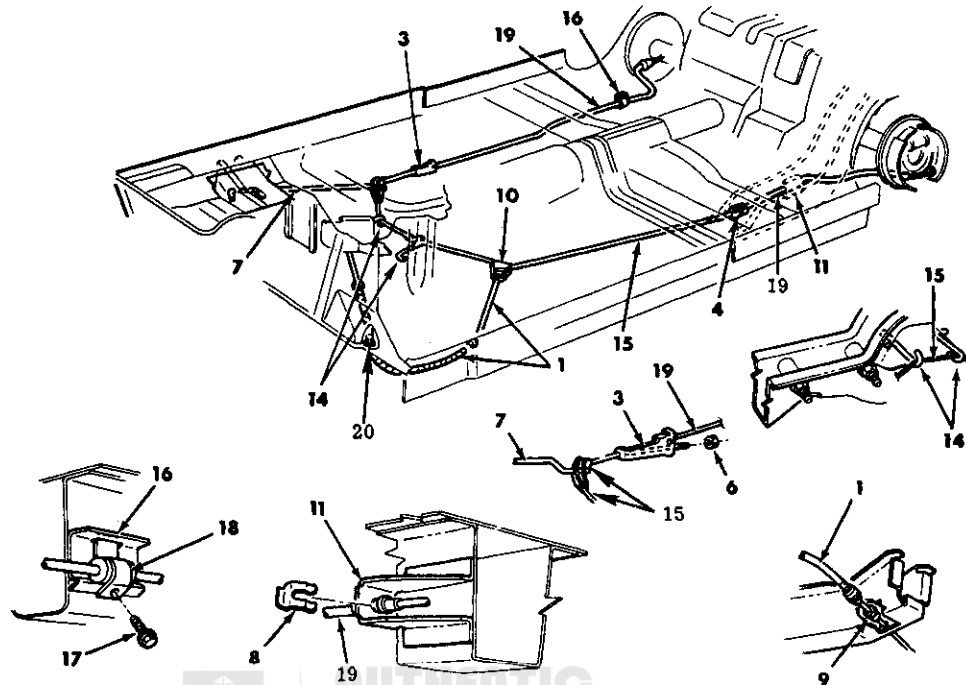

ITEM	PART NUMBER	QTY.	MODEL	DESCRIPTION
1	3766 292	1	All	CABLE, Frt.
3	3575 604	1	All	CONNECTOR, Brake Cable Adj.,Rt.
4	3766 234	1	All	CONNECTOR, Inter. To Rear Cable,Lt.
6	6030 607	1	All	NUT, Cable Adj.
7	3766 288	1	All	HOOK, Int. Cable Equalizer
8	2201 467	1	All	CLIP, Cable To Cable Supt.
9	3467 939	2	All	RETAINER, Cable Lower
10	3575 593	1	All	CONNECTOR, Frt. To Inter. Cable
11	3570 345	1	All	BRACKET, Rear Side Rail Cable, Lt.
14	3766 289	2	All	HOOK, Inter. Cable Guide
15	3766 230	1	H,N,29	CABLE, Inter. w/Equalizer
	3766 231	1	H,N,22,41,45	
	3766 231	1	F,G	
16	4073 057	1	All	BRACKET, Rear Side Rail Cable, Rt.
17		1	All	SCREW, (Not Serviced)
18	3699 186	1	All	CLAMP, Rear Cable Anchor, Rt.
19	3766 232	2	All	CABLE, Rear, Exc. Police & Taxi
	3766 233	2	H,N	Police & Taxi
20	2259 118	1	All	SEAL, Frt. Floor Pan Cable

**MODEL CODES:**  
**(CAR LINES)**M=Horizon  
Z=OmniH=Volare  
N=AspenF=Le Baron  
G=DiplomatX=Magnum XE  
S=CordobaE=St Regis  
T=Newport/New Yorker**BODY**  
**STYLES:** 22=2-Door Special Coupe  
42=4-Door Pillared Hardtop24=2-Door Hatchback  
44=4-Door Hatchback29=2-Door Special Coupe  
45=2-Seat Station Wagon

41=4-Door Sedan

AR=Use as Required

# =New Part Number

Printed in U.S.A.

June, 1979