

Fig. 4—Tape Connector and Wires

(14) Remove three housing cover screws and remove housing cover (Fig. 6). With cover removed, the wash/wipe switch may be removed. If required, the pivot pin can be pressed out with a punch. Also, if required, the tilt lever opening shield and dimmer switch actuator rod may be removed from cap.

(15) Place column in full "UP" position. Remove tilt spring retainer using a large Phillips screwdriver. Insert screwdriver in opening, press in approximately 3/16 inch; turn approximately 1/8 turn counterclockwise until ears align with grooves in housing and remove spring and guide (Fig. 8).

(16) Remove dimmer switch mounting screws. Remove dimmer switch. Separate dimmer switch from rod by pulling.

(17) Push upper steering shaft in sufficiently to remove steering shaft inner race seat and inner race.

(18) With ignition switch in "ACCESSORY" position, remove the ignition switch mounting

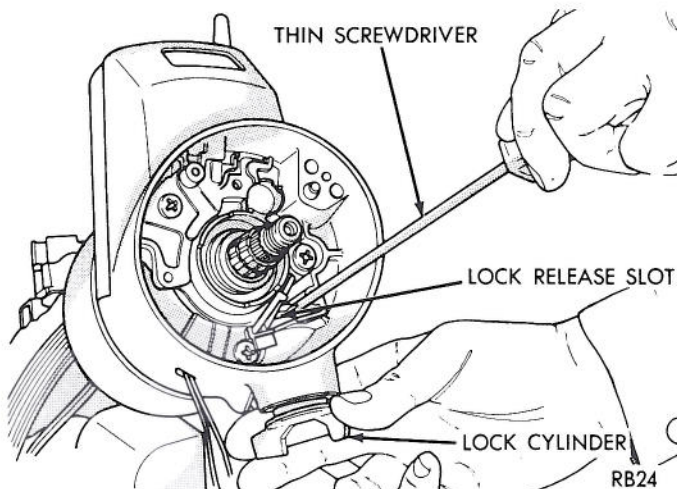

Fig. 5—Remove Lock Cylinder

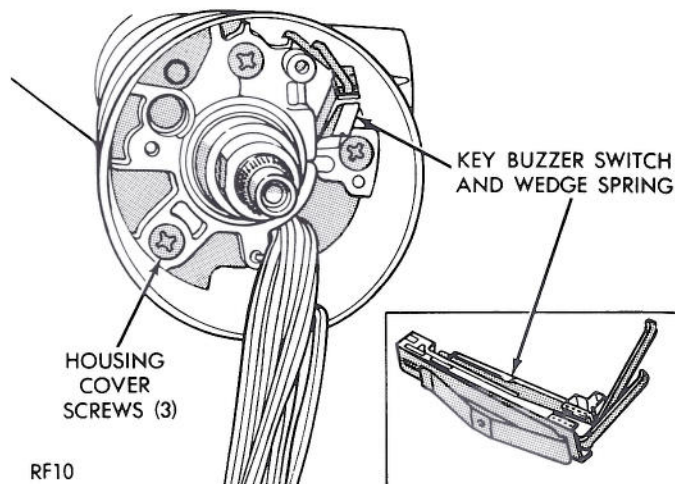

Fig. 6—Key Buzzer Switch and Wedge Spring

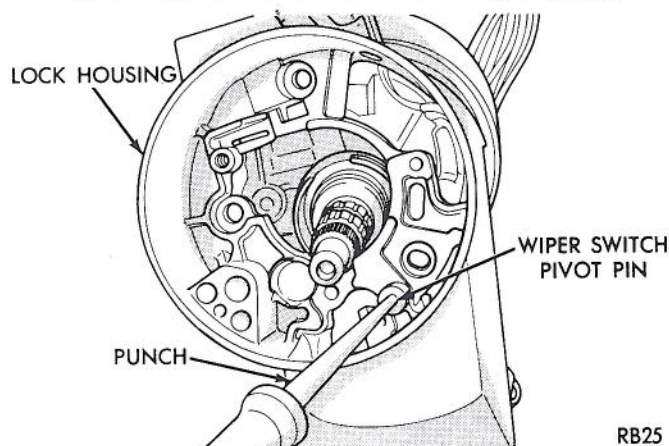

Fig. 7—Wiper Switch Pivot Pin

screws and ignition switch (Fig. 9).

(19) Place pivot pin remover C-4016 over pivot pin and thread small portion of screw firmly into the pin. Hold screw from turning with one wrench, turn nut clockwise with a second wrench to withdraw pivot pin from the support (Fig. 10). Remove opposite pivot pin in same manner.

(20) Use tilt release lever to disengage lock shoes. Remove bearing housing assembly by

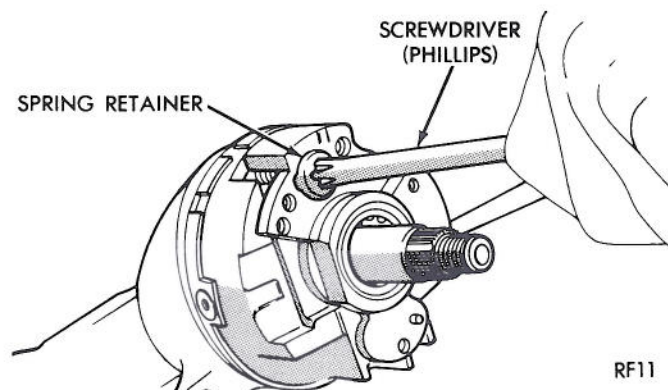

Fig. 8—Tilt Spring Retainer